



SINOVA, Miniature Circuit Breaker 415V 10kA, 2-pole C, 50 A

Model	
product brand name	SINOVA
General technical data	
number of poles	2
design of pole	2P
tripping characteristic class	C
overvoltage category	III
degree of pollution	2
operational current at AC rated value	50 A
Supply voltage	
value range of the supply voltage frequency	50/60 Hz
value range of the supply voltage at AC	240/415 V
protection class IP	IP20, with connected conductors
switching capacity current	
• according to EN 60898 rated value	10 kA
power loss [W]	
• for rated value of the current at AC in hot operating state per pole	5 W
• maximum	10 W
product feature silicon-free	Yes
product extension installable supplementary devices	No
connectable conductor cross-section solid	
• minimum	1 mm <sup>2</sup>
• maximum	35 mm <sup>2</sup>
connectable conductor cross-section stranded	
• minimum	1 mm <sup>2</sup>
• maximum	35 mm <sup>2</sup>
tightening torque with screw-type terminals	
• minimum	2 N·m
• maximum	2 N·m
position of power supply cord	Any
height	84 mm
width	36 mm
depth	76 mm
installation depth	70 mm
number of modular width units	2
fastening method	DIN rail
mounting position	any
net weight	220 g
ambient temperature during operation	

• minimum	-25 °C
• maximum	55 °C
<b>ambient temperature during storage</b>	
• minimum	-40 °C
• maximum	75 °C
<b>reference code according to IEC 81346-2</b>	F
<b>Further information</b>	

**Information on the packaging**

<https://support.industry.siemens.com/cs/ww/en/view/109813875>

**Information- and Downloadcenter (Catalogs, Brochures,...)**

<http://www.siemens.com/lowvoltage/catalogs>

**Industry Mall (Online ordering system)**

<https://mall.industry.siemens.com/mall/en/en/Catalog/product?mlfb=5TJ4250-7>

**Service&Support (Manuals, Certificates, Characteristics, FAQs,...)**

<https://support.industry.siemens.com/cs/ww/en/ps/5TJ4250-7>

**Image database (product images, 2D dimension drawings, 3D models, device circuit diagrams, ...)**

[http://www.automation.siemens.com/bilddb/cax\\_en.aspx?mlfb=5TJ4250-7](http://www.automation.siemens.com/bilddb/cax_en.aspx?mlfb=5TJ4250-7)

**CAX-Online-Generator**

<http://www.siemens.com/cax>

**Tender specifications**

<http://www.siemens.com/specifications>

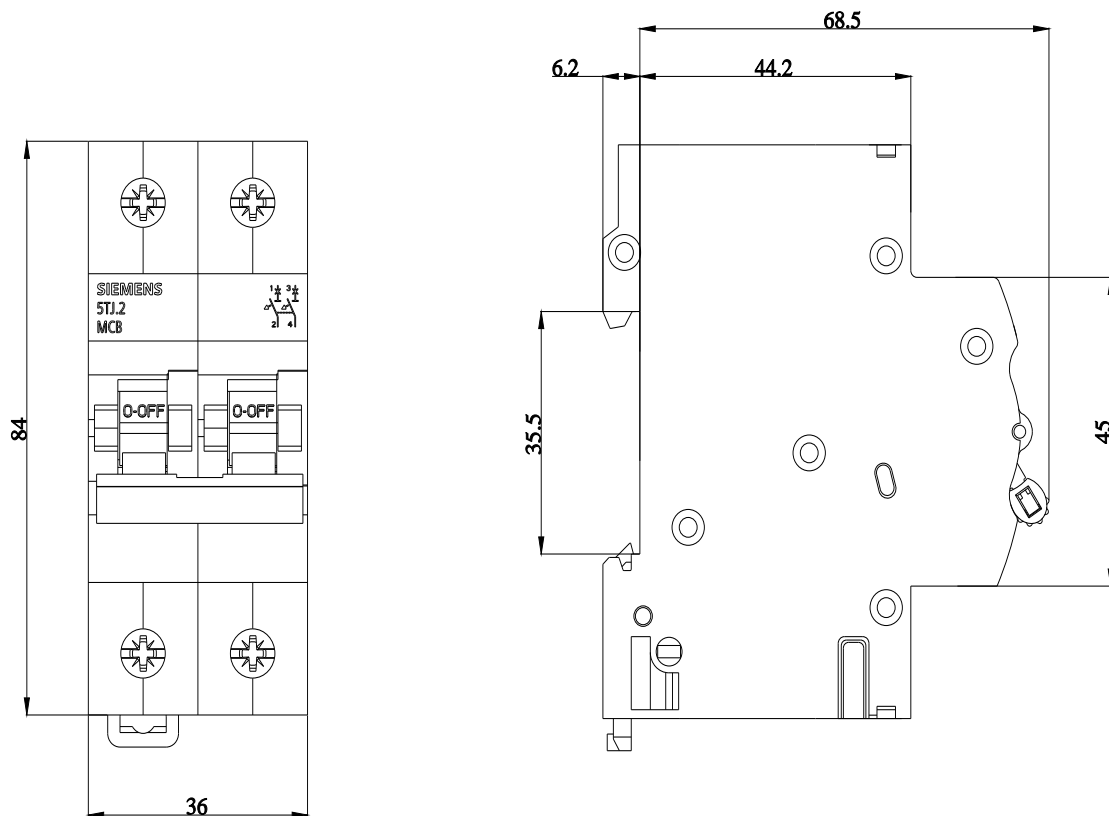

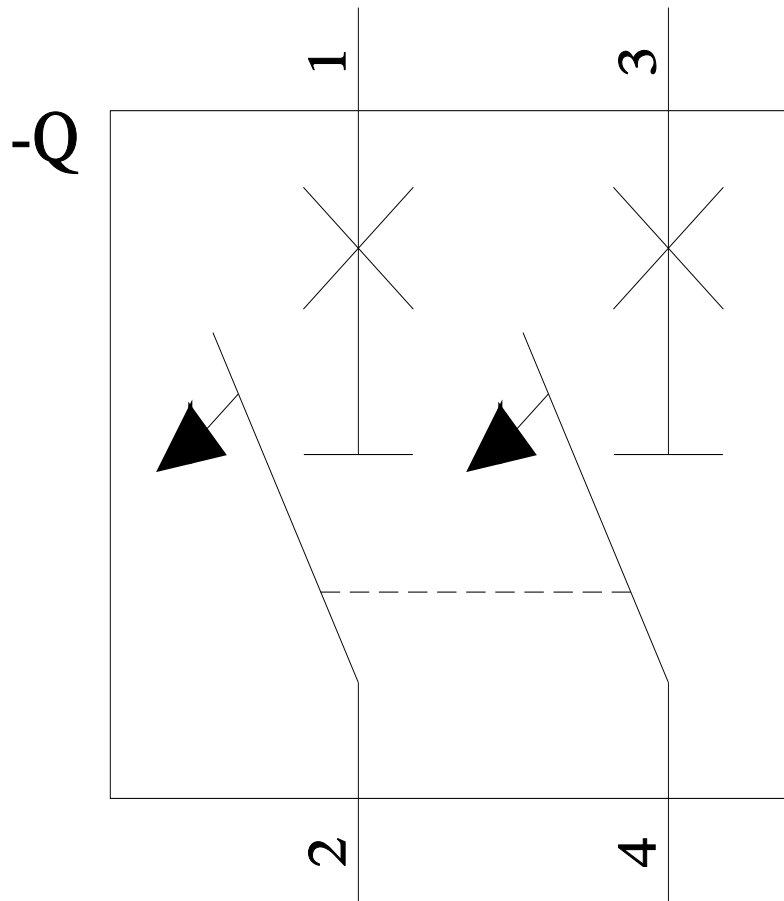

last modified:

4/19/2024 

